

**TOSHIBA**



For CANVIO AeroCast / CANVIO AeroCast wireless HDD

# **Manual for disconnecting from the internet.**

Manual Version 1.00

## Revision History

---

Version	Revision Date	Description
01	July 20, 2018	Initial release

## **Notice**

---

The information contained in this manual, including but not limited to any product specifications, is subject to change without notice.

TOSHIBA ELECTRONIC DEVICES & STORAGE CORPORATION AND ITS SUBSIDIARIES AND AFFILIATES ("TOSHIBA") PROVIDE NO WARRANTY WITH REGARD TO THIS MANUAL OR ANY OTHER INFORMATION CONTAINED HEREIN AND HEREBY EXPRESSLY DISCLAIM ANY IMPLIED WARRANTIES OF MERCHANTABILITY OR FITNESS FOR ANY PARTICULAR PURPOSE WITH REGARD TO ANY OF THE FOREGOING. TOSHIBA ASSUMES NO LIABILITY FOR ANY DAMAGES INCURRED DIRECTLY OR INDIRECTLY FROM ANY TECHNICAL OR TYPOGRAPHICAL ERRORS OR OMISSIONS CONTAINED HEREIN OR FOR DISCREPANCIES BETWEEN THE PRODUCT AND THE MANUAL. IN NO EVENT SHALL TOSHIBA BE LIABLE FOR ANY INCIDENTAL, CONSEQUENTIAL, SPECIAL, OR EXEMPLARY DAMAGES, WHETHER BASED ON TORT, CONTRACT OR OTHERWISE, ARISING OUT OF OR IN CONNECTION WITH THIS MANUAL OR ANY OTHER INFORMATION CONTAINED HEREIN OR THE USE THEREOF.

## **DISCLAIMER**

---

We assume no responsibility whatsoever for any damage or loss resulting from the use of this application.

THIS APPLICATION IS PROVIDED "AS IS" WITHOUT WARRANTIES OF ANY KIND. WITHOUT LIMITING THE FOREGOING, TOSHIBA DISCLAIMS ALL WARRANTIES AND REPRESENTATIONS OF ANY KIND RELATING TO THE APPLICATION, WHETHER EXPRESS, IMPLIED, OR STATUTORY, INCLUDING WITHOUT LIMITATION THE IMPLIED WARRANTIES OF MERCHANTABILITY, FITNESS FOR A PARTICULAR PURPOSE, ACCURACY, OR NONINFRINGEMENT OF THIRD PARTY RIGHTS. TOSHIBA DOES NOT WARRANT THAT THE OPERATION OF THE APPLICATION WILL BE UNINTERRUPTED, ERROR-FREE, OR SECURE. ANY INSTALLATION AND/OR USE OF THE APPLICATION SHALL BE AT YOUR OWN RISK.

## About Trademarks

---

Android is a trademark of Google Inc.



IOS is a trademark or registered trademark of Cisco in the U.S, and other countries and is used under licenses.

All other company names, product names, and service names mentioned herein may be trademarks of their respective companies.

## Safety Precautions

---

This section lists important precautions which users of our product(s) (and anyone else) should observe in order to avoid injury and damage to property, and to ensure safe and correct use of our products. Please be sure that you understand the meanings of the labels and graphic symbols described below before you move on to the detailed descriptions of the precautions, and comply with the precautions stated.

 <b>DANGER</b>	Indicate an imminently hazardous situation which, if not avoided, will result in death or serious injury.
 <b>WARNING</b>	Indicate a potentially hazardous situation which, if not avoided, could result in death or serious injury.
 <b>CAUTION</b>	Indicate a potentially hazardous situation which, if not avoided, could result in minor or moderate injury.
<b>NOTICE</b>	Indicates practices that may cause property damage and other problems, but not personal injury.
<b>NOTE</b>	Provides important information.

\*Serious injury including blindness, wounds, burns (low and high temperature), electric shock, fractures, and poisoning, etc. with long-lasting effects or that require hospitalization and/or long-term hospital visits for treatment.

\*Minor or moderate injury includes wounds, burns, electric shock, etc. not requiring hospitalization and/or long-term hospital visits for treatment.

\*Property damage means damage to device.

## Table of Contents

---

Introduction.....	5
Procedure to disconnect the internet .....	6

### ■ Explanation of marks in this document



#### **Information**

Describes functions, restrictions, and matters for reference.



#### **Note**

Describes additional instructions and notes.

# Introduction

---

This document explaining the procedure to disconnect Canvio AeroCast from the internet.

Please read this document carefully before executing.



**Information**

Remember to backup all data on the device to another computer or storage media before executing. Toshiba will not be responsible for any damage caused by this.

# Procedure to disconnect the internet

---

Internet connection is disconnected by the following instructions.

1. In case of the low battery, plug the AC adaptor to a power outlet, and then plug the USB cable from AC adaptor to the AeroCast.

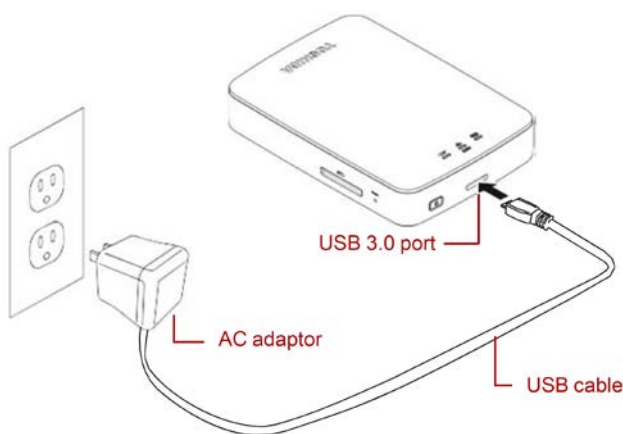

2. Press the ON/OFF button to power on the AeroCast.
3. Press and hold Reset button for 5 seconds. The system will restore to its factory settings. The AeroCast will reboot.

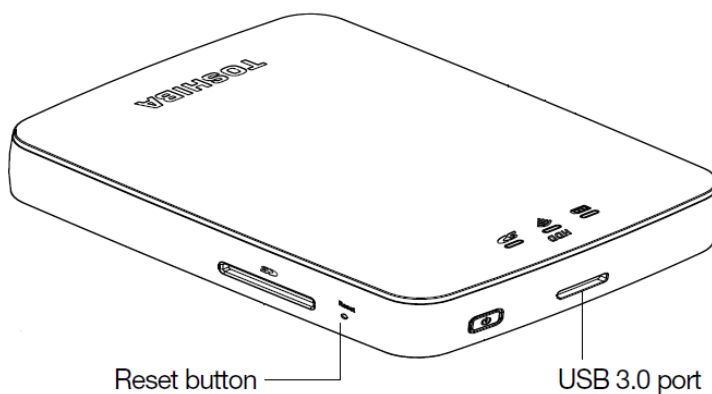

4. Power on your Android™ or iOS Device, then call the wireless settings screen on your local device and connect to the AeroCast wirelessly. (Displayed SSID is "Toshiba\_whdd\_\*\*\*\*". (\*\*\*\* are unique digits or characters.)). Wireless network password is restored to its factory setting character "12345678".

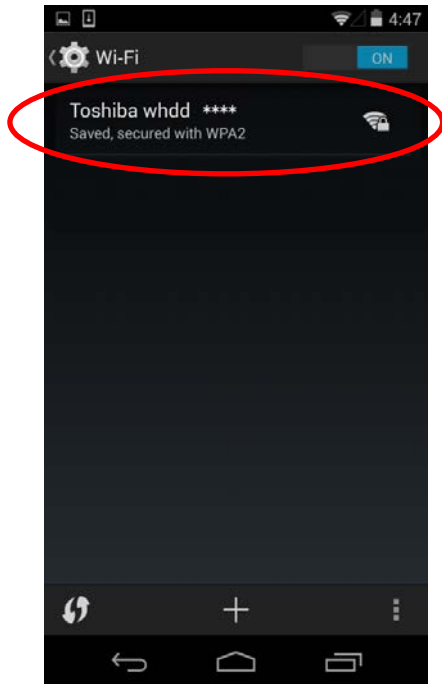

 Please be sure to change the default password immediately upon first usage of the product.

**Information**

(PW

5. Return to your device initial menu, and then start "Toshiba Wireless HDD" app.



6. Touch “” icon.

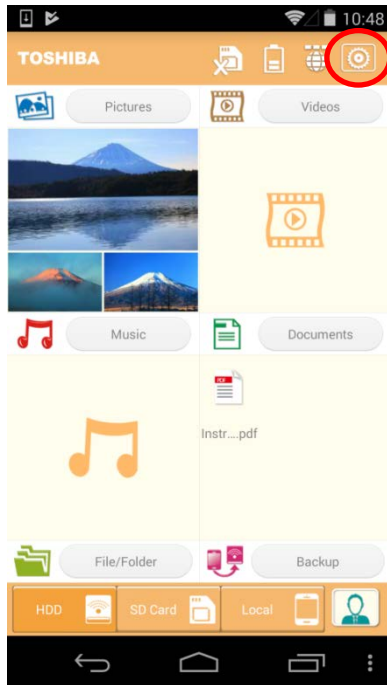

7. Touch **Information**.

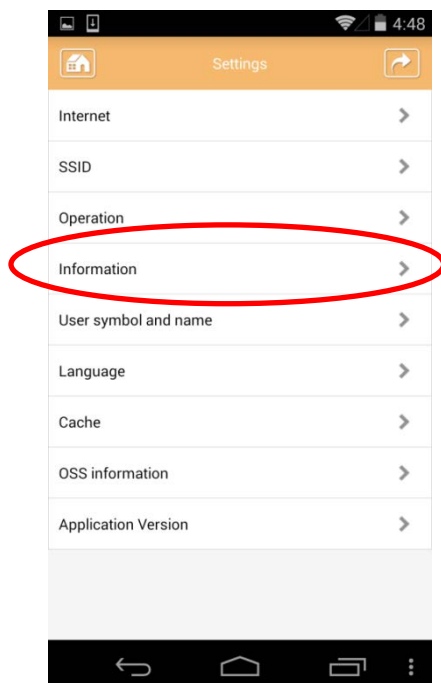

8. Please confirm Firmware Version is "1.2.8".

In case the firmware version is "1.2.6" or earlier, please be sure to update firmware following the website, and then back to procedure No.1.

([http://www.canvio.jp/en/news/hdd/ot\\_notice/20171017.htm](http://www.canvio.jp/en/news/hdd/ot_notice/20171017.htm))



9. Touch "⏪" icon.

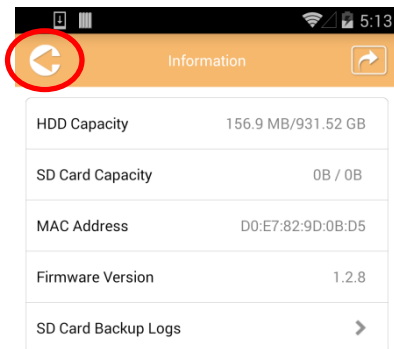

10. Touch **SSID**.

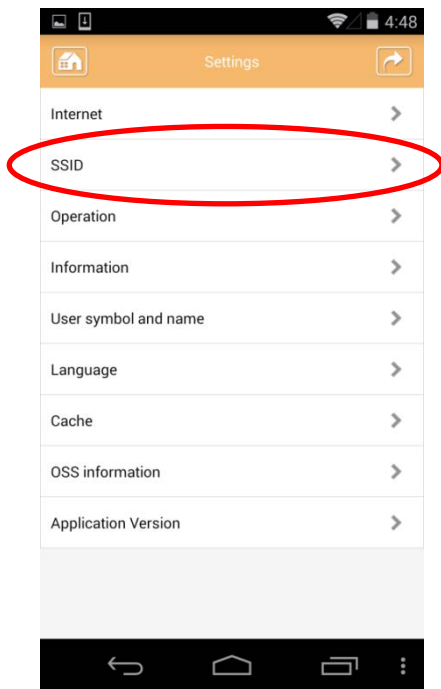

11. Touch **Modify password**.

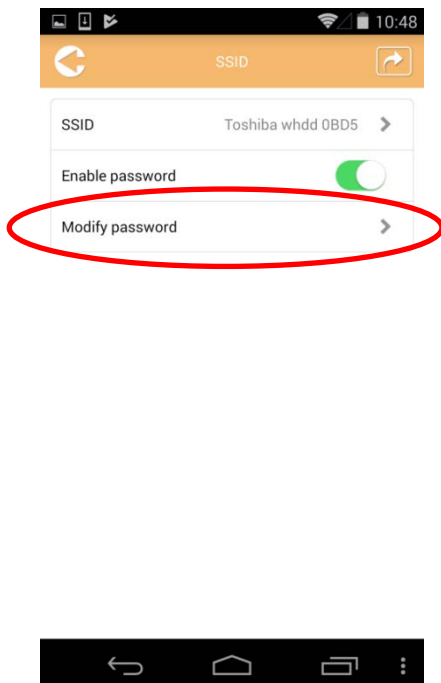

12. To change wireless network password from default settings, input your unique password character, and then touch **OK**.

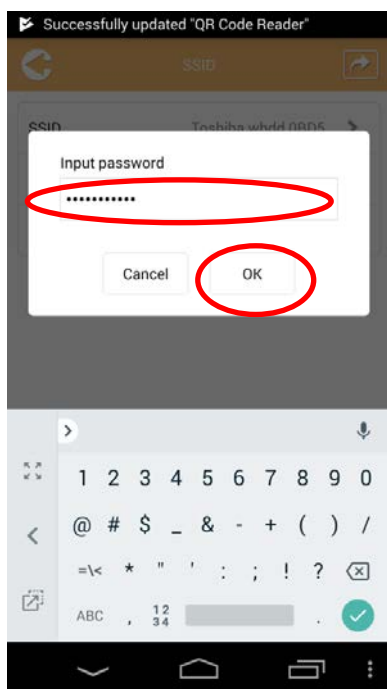

13. Touch **Apply** for applying your unique password.

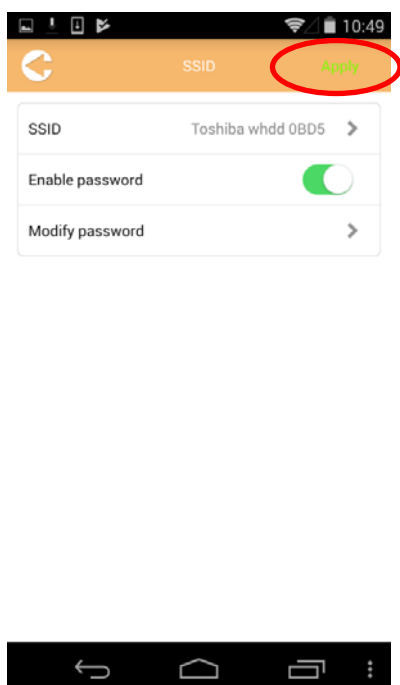

14. Touch **OK**, and then the AeroCast will reboot.

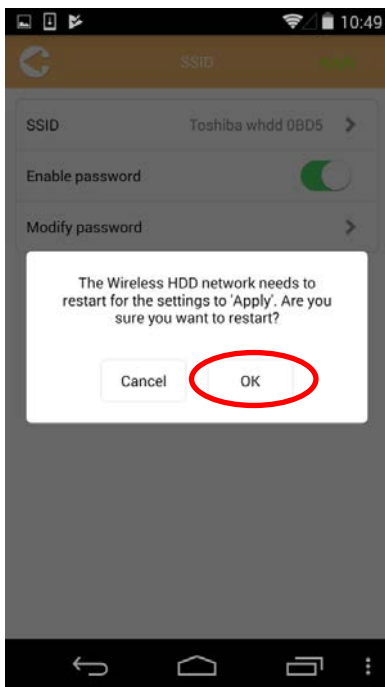

15. Touch **OK**, and then call the wireless settings screen on your local device.

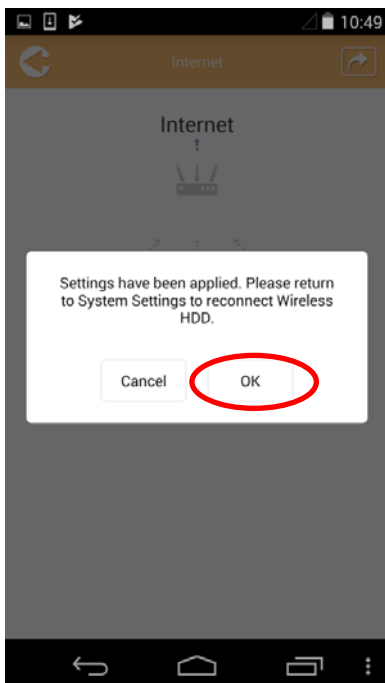

16. The wireless settings screen on your local device and connect to the AeroCast wirelessly. (Displayed SSID is "Toshiba\_whdd\_\*\*\*\*". (\*\*\*\* are unique digits or characters.)). Wireless network password is the character which you set previously.

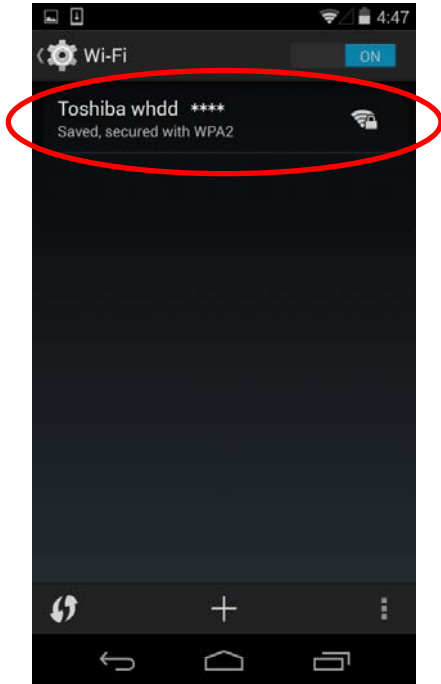

17. Return to your device initial menu, and then start "Toshiba Wireless HDD" app.

18. Touch “” icon.

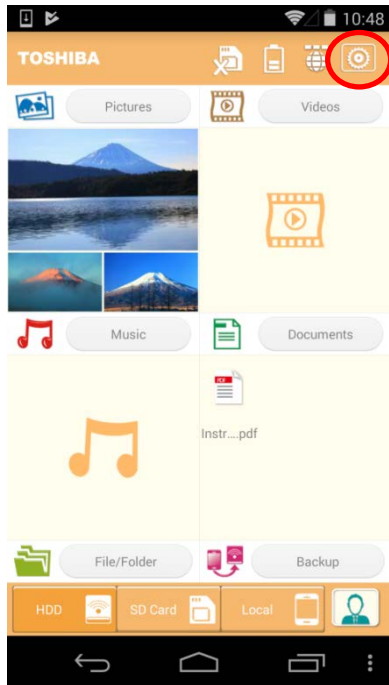

19. Touch **Internet**.

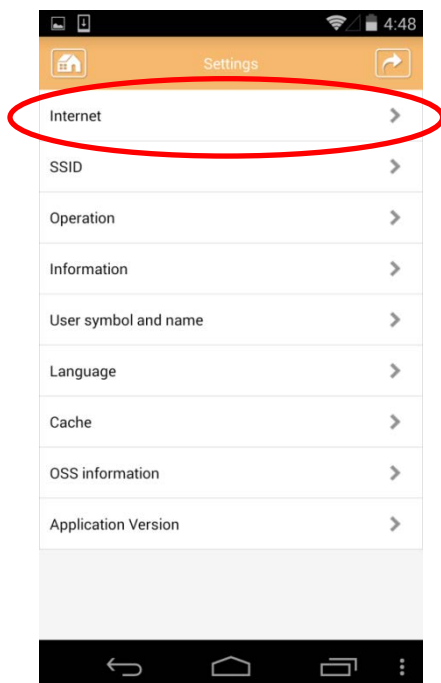

20. Please confirm wireless router icon is gray scale (not purple). It means internet is not connected. (Please refer below figure.)  
In case wireless router icon is purple, back to procedure No.3.

OK case  
(Internet is not connected)



NG case  
(Internet is connected)

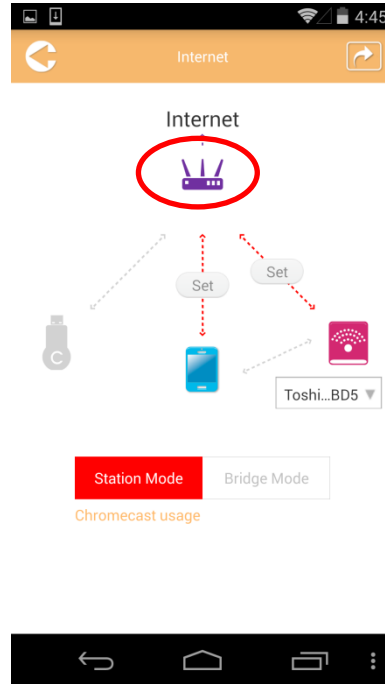

21. Return to main app menu.



**TOSHIBA ELECTRONIC DEVICES & STORAGE CORPORATION**

1-1, Shibaura 1-Chome, Minato-ku, Tokyo 105-0023, Japan

© 2018 TOSHIBA ELECTRONIC DEVICES & STORAGE CORPORATION, All Rights Reserved.