

TLP848

- Camera Module for Mobile Phone
- Digital Still Camera and Video Camera
- Personal Equipment and Small-sized OA Equipment

The TLP848 is a surface-mount photointerrupter which is composed of a GaAs infrared LED and a Si phototransistor.

It is an ultra compact package. Moreover it has a wider gap width than 1mm gap width of industry-standard and has a high resolution.

- Ultra compact package : 2.8×1.9×2.5mm (typ.)
- Surface-mount type
- Gap width : 1.2mm (typ.)
- High resolution : Slit width 0.3 mm (typ.)
- High current transfer ratio : $I_C/I_F = 3\%$ (min)
- Material of the package : PPS (Polyphenylene sulfide)
(UL94V-0)

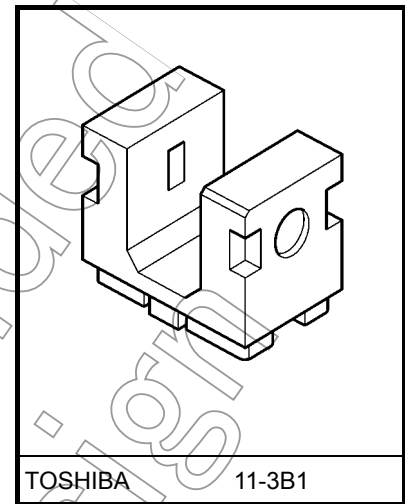

TOSHIBA 11-3B1

Weight: 0.017 g (typ.)

Absolute Maximum Ratings (Ta = 25°C)

Marking (Note 2)

Characteristics		Symbol	Rating	Unit
LED	Forward current	I_F	30	mA
	Forward current derating (Ta>25°C)	$\Delta I_F/^\circ\text{C}$	-0.33	mA/°C
	Reverse voltage	V_R	5	V
Detector	Collector-emitter voltage	V_{CEO}	15	V
	Emitter-collector voltage	V_{ECO}	5	V
	Collector power dissipation	P_C	75	mW
	Collector power dissipation derating (Ta>25°C)	$\Delta P_C/^\circ\text{C}$	-1	mW/°C
	Collector current	I_C	50	mA
Operating temperature range		T_{opr}	-30 to 85	°C
Storage temperature range		T_{stg}	-40 to 100	°C
Soldering temperature (Note 1)		T_{sol}	250	°C

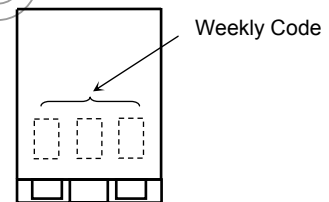

Note: Using continuously under heavy loads (e.g. the application of high temperature/current/voltage and the significant change in temperature, etc.) may cause this product to decrease in the reliability significantly even if the operating conditions (i.e. operating temperature/current/voltage, etc.) are within the absolute maximum ratings.

Please design the appropriate reliability upon reviewing the Toshiba Semiconductor Reliability Handbook ("Handling Precautions"/"Derating Concept and Methods") and individual reliability data (i.e. reliability test report and estimated failure rate, etc).

Note 1: The reflow time and the example of temperature profile are shown in the section entitled Mounting Method.

Note 2: Weekly code: (Three digits)

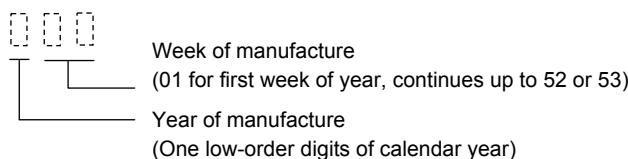

Optical and Electrical Characteristics (Ta = 25°C)

Characteristics		Symbol	Test conditions	Min	Typ.	Max	Unit	
LED	Forward voltage	V_F	$I_F = 10 \text{ mA}$	1.10	1.23	1.40	V	
	Reverse current	I_R	$V_R = 5 \text{ V}$	—	—	10	μA	
	Peak emission wavelength	λ_P	$I_F = 10 \text{ mA}$	—	940	—	nm	
Detector	Dark current	$I_D (I_{CEO})$	$V_{CE} = 12 \text{ V}, I_F = 0$	—	—	0.05	μA	
	Peak sensitivity wavelength	λ_P	—	—	820	—	nm	
Coupled	Current transfer ratio	I_C/I_F	$V_{CE} = 2 \text{ V}$ $I_F = 5 \text{ mA}$	TLP848	3	—	24	%
				TLP848 (R)	4	—	20	%
	Collector-emitter saturation voltage	$V_{CE(sat)}$	$I_F = 10 \text{ mA}, I_C = 0.15 \text{ mA}$	—	0.1	0.4	V	
	Rise time	t_r	$V_{CC} = 5 \text{ V}, I_C = 1 \text{ mA}$	—	15	50	μs	
	Fall time	t_f	$R_L = 1 \text{ k}\Omega$ (Note 3)	—	15	50		

Note 3: Switching time measurement circuit and waveform



Package Dimensions: TOSHIBA 11-3B1

Unit: mm

Tolerance : ± 0.1 mm unless otherwise specified

() : Reference value

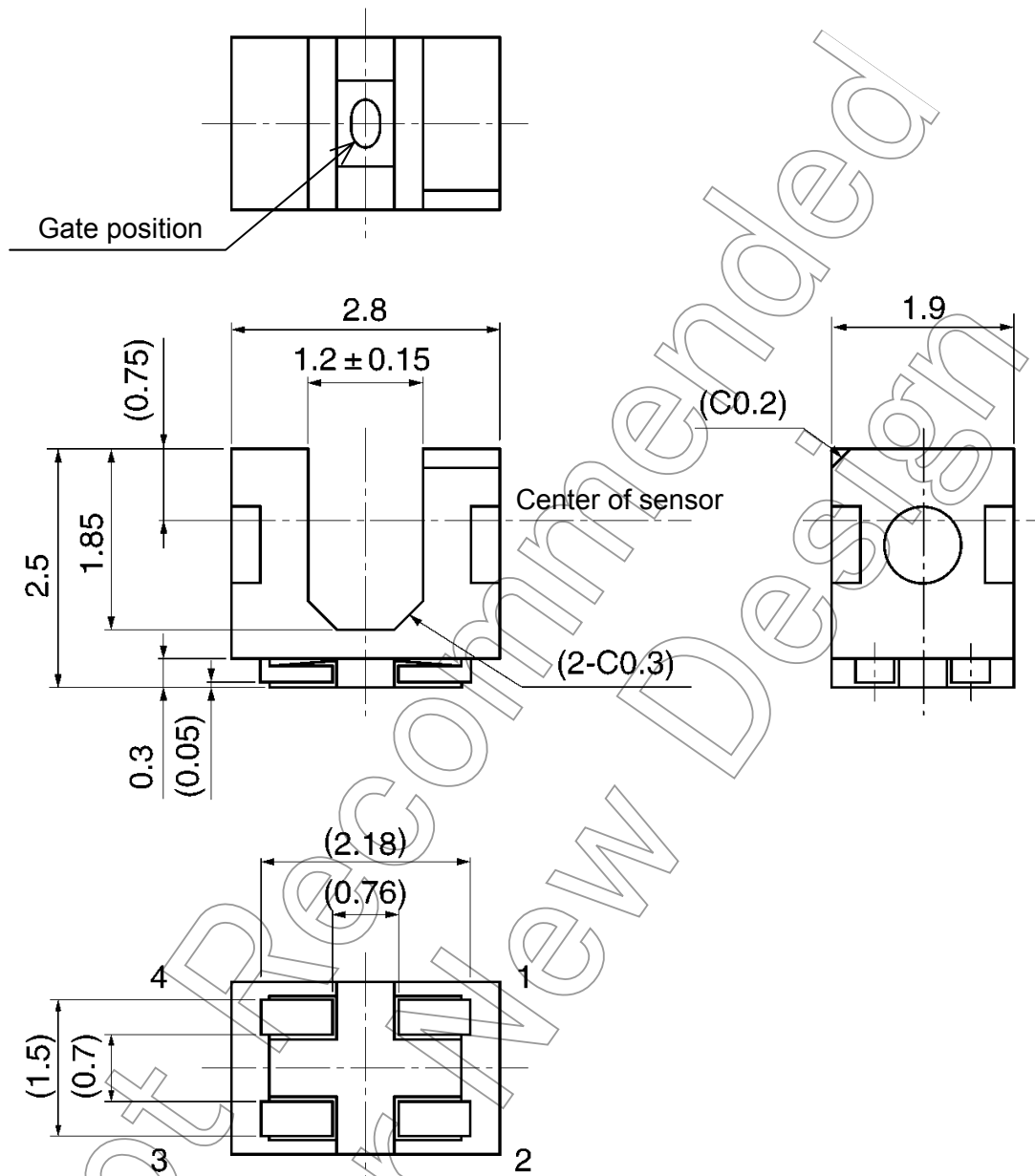

Weight: 0.017 g (typ.)

Pin Connection

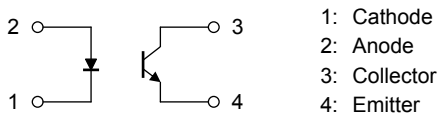

Handling and Mounting Precautions

- Care must be taken in relation to the environment in which the device is to be installed. Oil or chemicals may cause the package to melt or crack.
- The device should be mounted on an unwarped surface.
- Do not apply stress to the resin at high temperature.
- The resin part is easily scratched, so avoid friction with hard materials.
- When installing the assembly board in equipment, ensure that this product does not come into contact with other components.
- Conversion efficiency falls over time due to the current which flows in the infrared LED. When designing a circuit, take into account this change in conversion efficiency over time. The ratio of fluctuation in conversion efficiency to fluctuation in infrared LED optical output is 1:1.

$$\frac{IC/IF(t)}{IC/IF(0)} = \frac{P_o(t)}{P_o(0)}$$

Moisture-Proof Packing

- To avoid moisture absorption, the reel is packed in an aluminum bag that contains a desiccant with a humidity indicator. Since the optical characteristics of the photointerrupter may be affected during soldering by vaporization of the moisture which is absorbed in storable period, it should be stored under the following conditions:
 1. If the aluminum bag has been stored unopened
 - Temperature: 5 to 30°C
 - Relative humidity: 90% RH (max)
 - Time: 12 months
 2. If the aluminum bag has been opened
 - Temperature: 5 to 30°C
 - Relative humidity: 70% RH (max)
 - Time: 168 h
 3. Baking should be conducted within 72 h after the humidity indicator shows > 30% or the bag seal date is over 12 months. The number of baking should be once. If the baking is conducted repeatedly, it may affect the peel-back force and cause a problem for mounting.
 - Baking condition: 60 ± 5°C, 12 to 24 h
 - Storage period: 12 months from the seal date on the label
 4. When the photointerrupter is baked, protect it from electrostatic discharge.
 5. Do not toss or drop to avoid damaging the moisture-proof bag.

Mounting Methods

1. The example of temperature profile (reflow soldering)

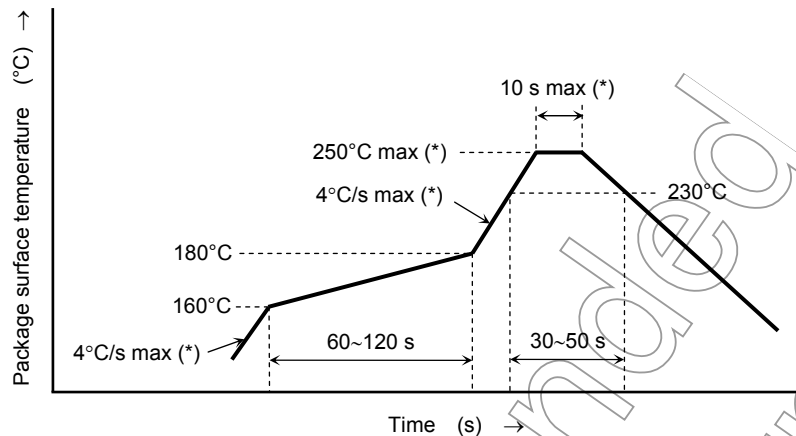

(*)The product is evaluated using above reflow soldering conditions. No additional test is performed exceed the condition (i.e. the condition more than MAX values) as an evaluation. Please perform reflow soldering under the above conditions.

- The first reflow process should be performed under the above temperature profile within 168 h after opening the bag.
- If a second reflow process needs to be performed, it should be performed within 168 h of the first reflow under the above temperature profile.
- Storage conditions before the second reflow process: 30°C, 70% RH (max)
- Do not perform wave soldering and manual soldering with a soldering iron.

2. Recommended soldering pattern

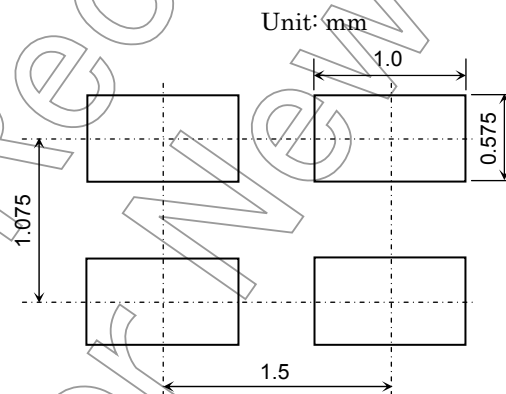

3. Cleaning

When cleaning is required after soldering, Toshiba recommends the following cleaning solvents. It is confirmed that these solvents have no effect on semiconductor devices in our dipping test (under the recommended conditions).

In selecting the one for your actual usage, please perform sufficient review on washing condition, using condition and etc.

- | | |
|------------------------------------------------|----------------------------------|
| ASAHI CLEAN AK-225AES | : (made by ASAHI GLASS) |
| KAO CLEAN TROUGH 750H | : (made by KAO) |
| PINE ALPHA ST-100S | : (made by ARAKAWA CHEMICAL) |
| TOSHIBA TECHNOCARE
(FRW-17, FRW-1, FRV-100) | : (made by GE TOSHIBA SILICONES) |

Packing Specification

1. Tape dimensions

Unit: mm

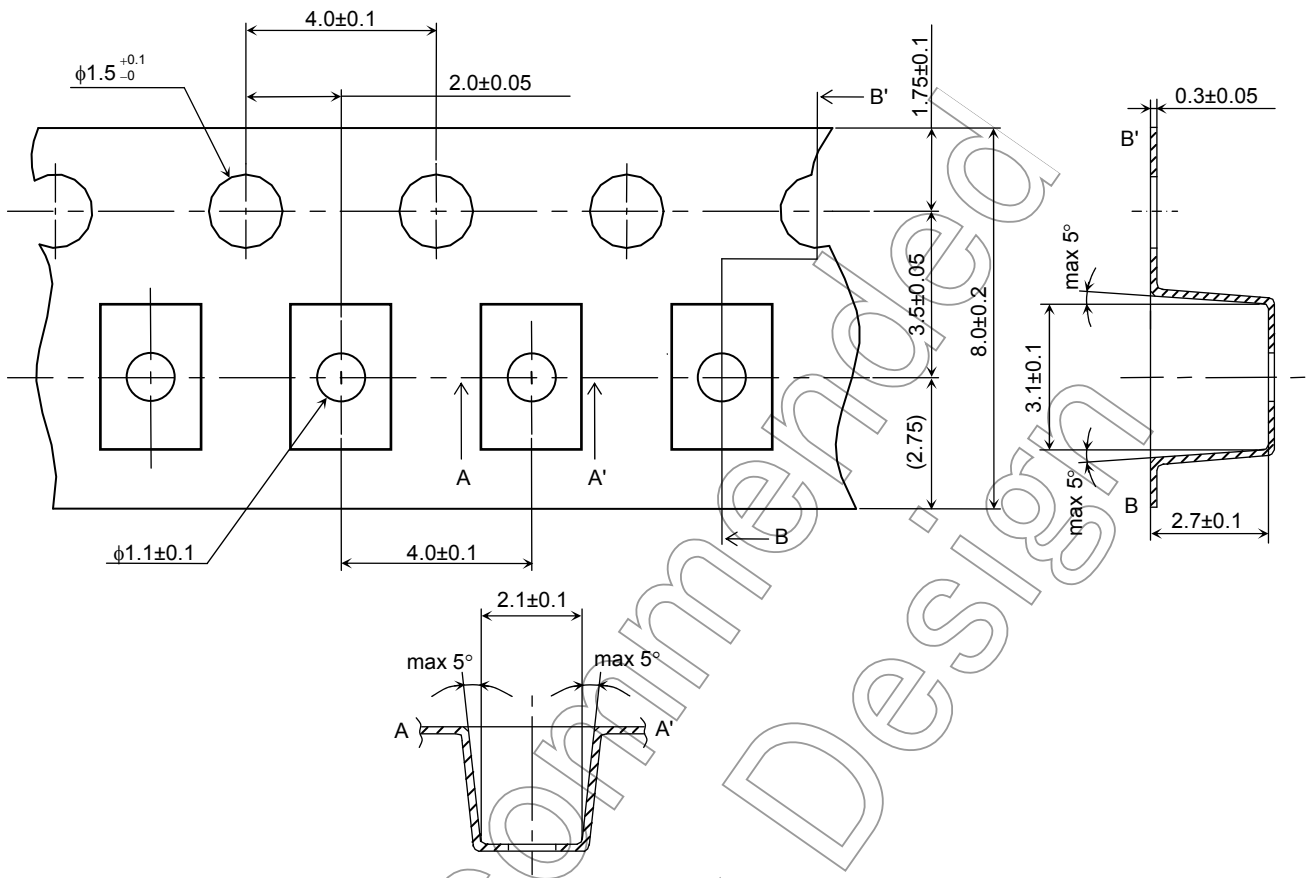

Device direction

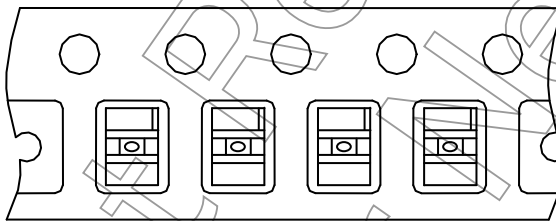

2. Reel dimensions

Unit: mm

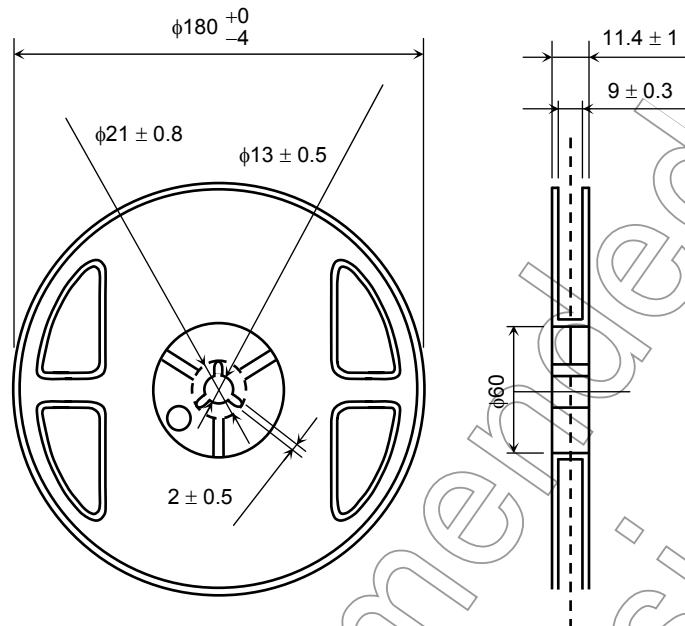

3. Leader and trailer sections of tape

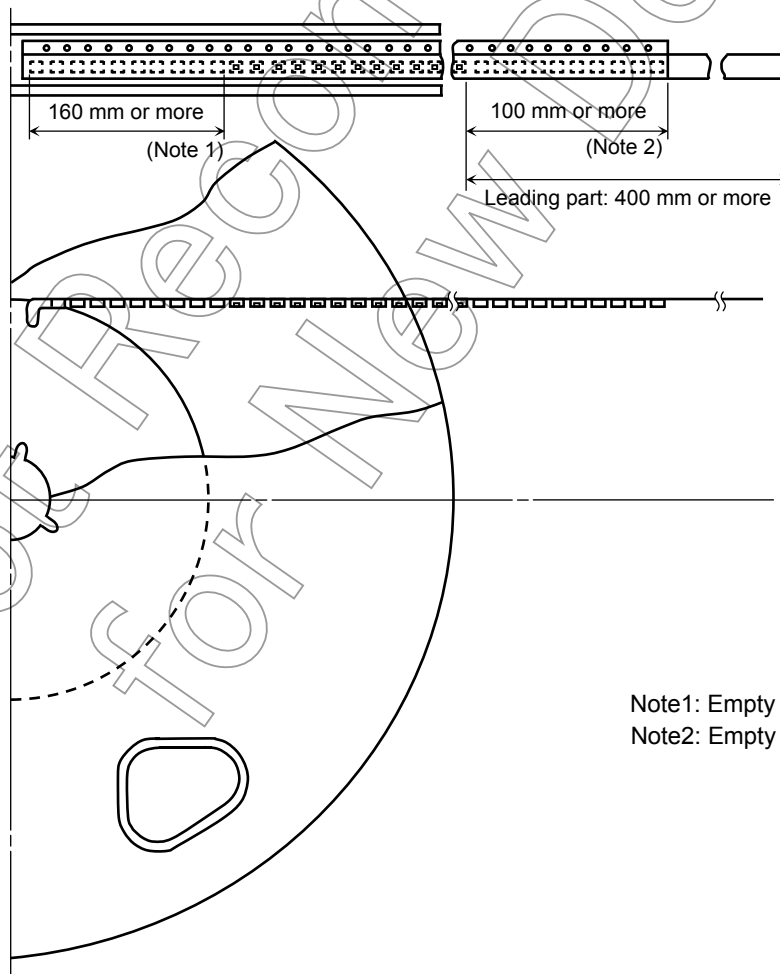

4. Packing format

(1) Packing quantity

Reel	1,500 pcs
Carton	7,500 pcs

(2) Packing form

Each reel is sealed in an aluminum bag that contains a desiccant with a humidity indicator.

Not Recommended
for New Design

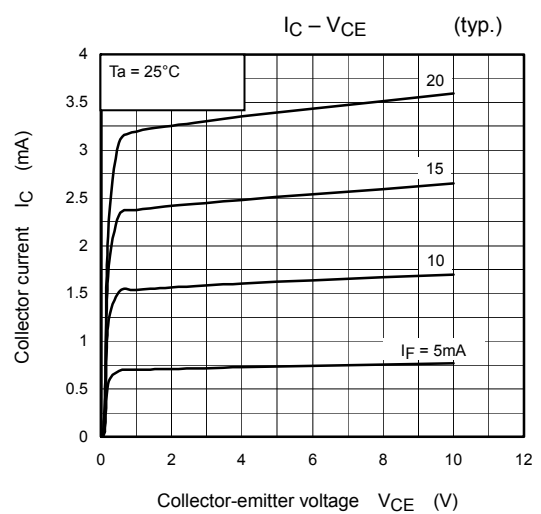
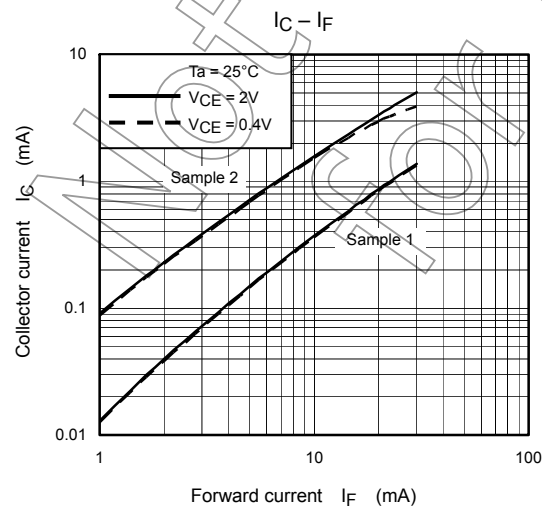
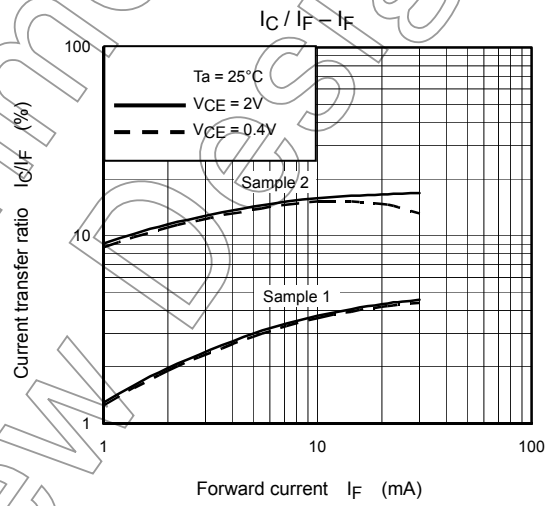
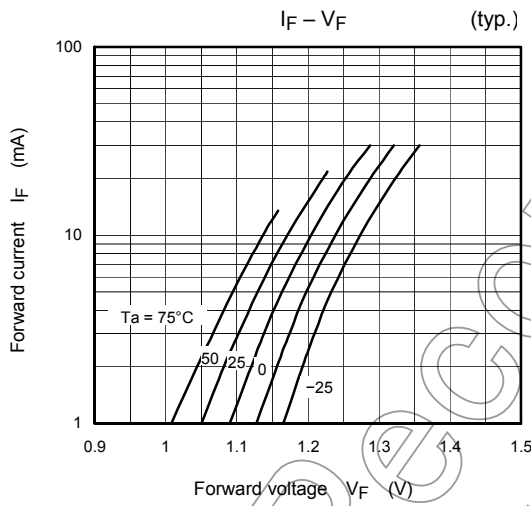
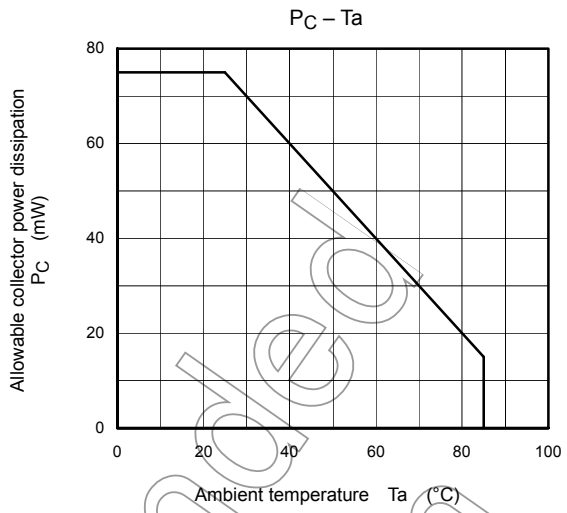
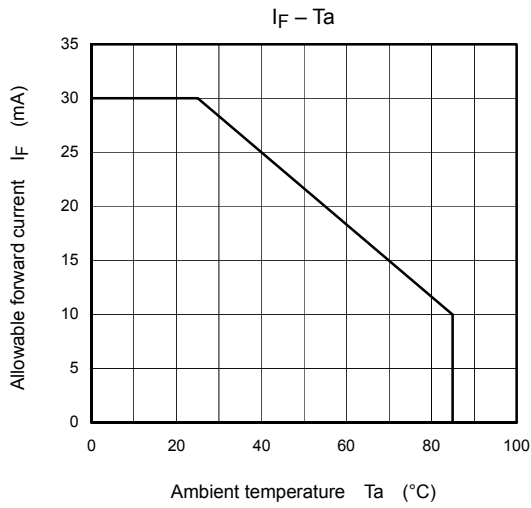

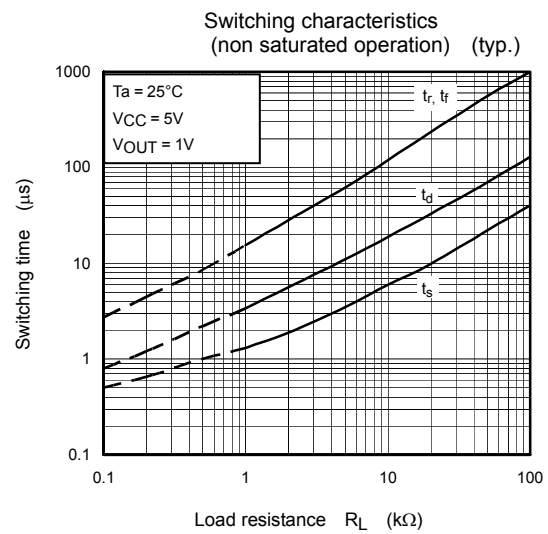
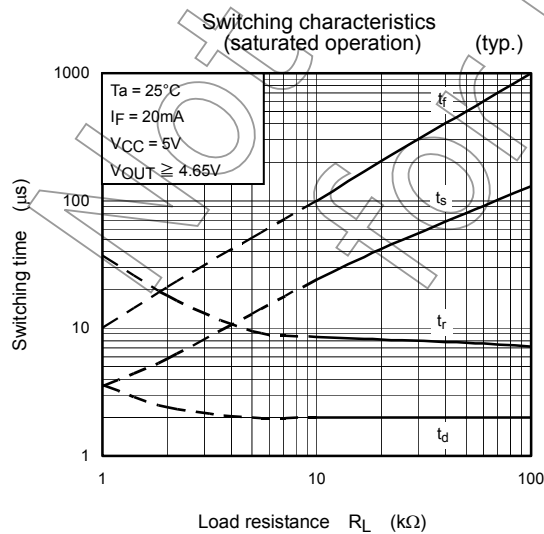
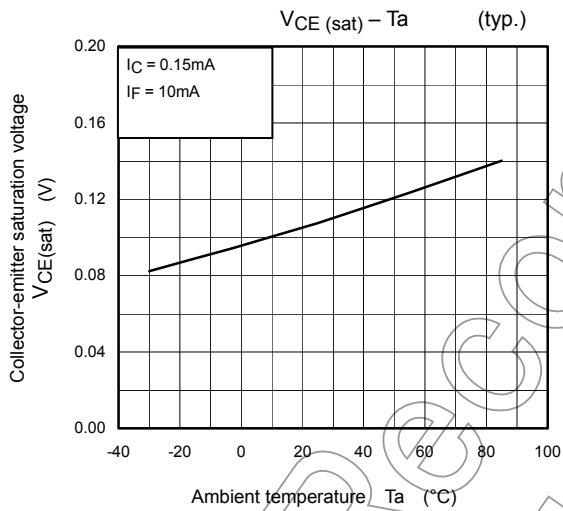
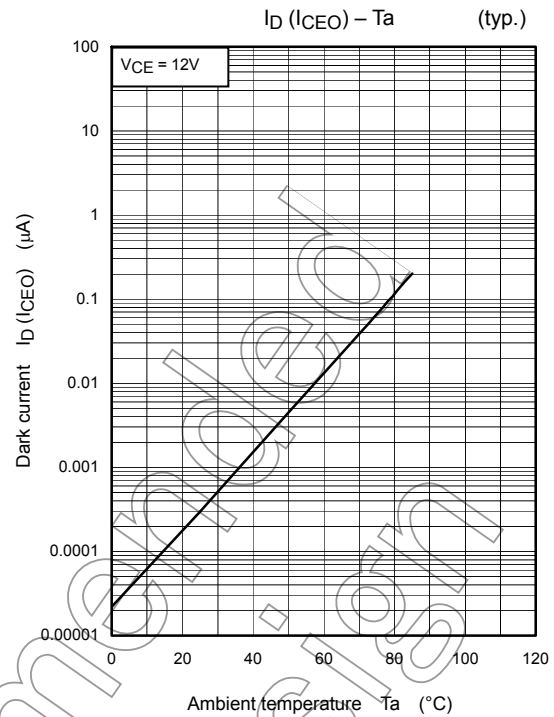
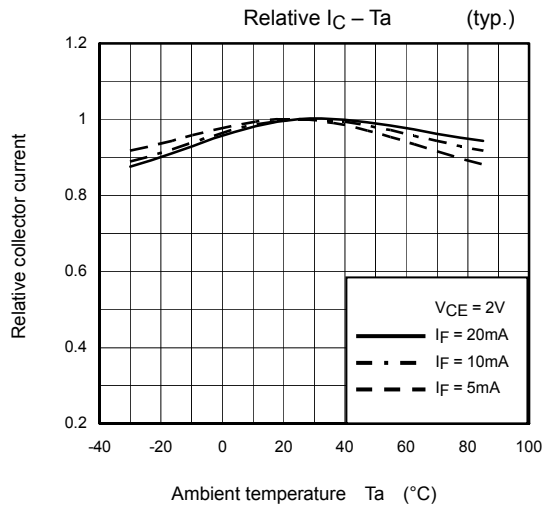

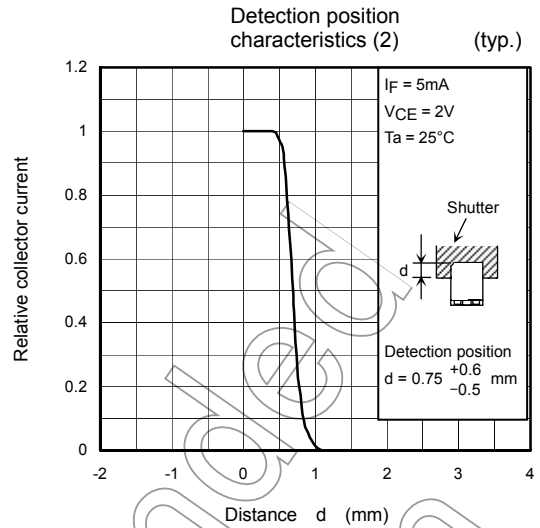
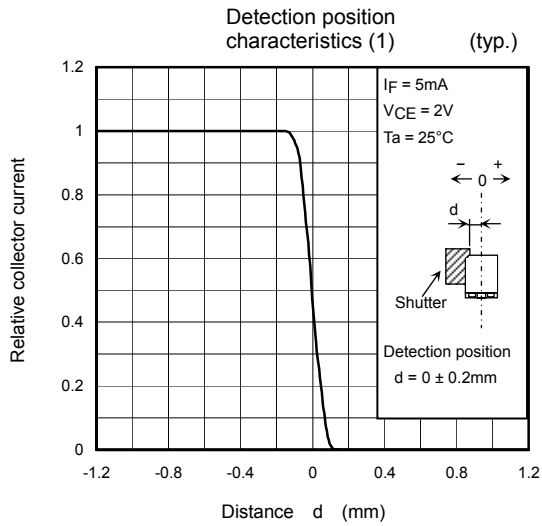

Relative Positioning of Shutter and Device

For normal operation, position the shutter and the device as shown in the figure below. By considering the device's detection direction characteristic and switching time, determine the shutter slit width and pitch.

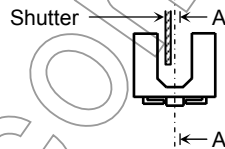

Unit: mm

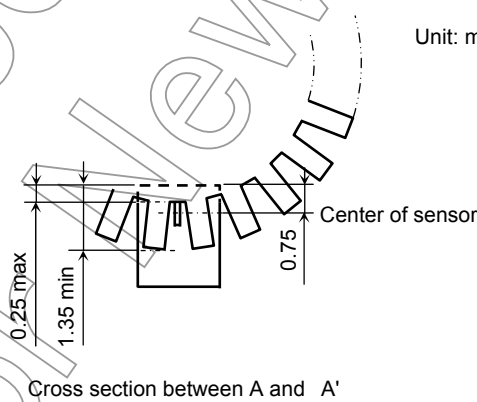

RESTRICTIONS ON PRODUCT USE

- Toshiba Corporation, and its subsidiaries and affiliates (collectively "TOSHIBA"), reserve the right to make changes to the information in this document, and related hardware, software and systems (collectively "Product") without notice.
- This document and any information herein may not be reproduced without prior written permission from TOSHIBA. Even with TOSHIBA's written permission, reproduction is permissible only if reproduction is without alteration/omission.
- Though TOSHIBA works continually to improve Product's quality and reliability, Product can malfunction or fail. Customers are responsible for complying with safety standards and for providing adequate designs and safeguards for their hardware, software and systems which minimize risk and avoid situations in which a malfunction or failure of Product could cause loss of human life, bodily injury or damage to property, including data loss or corruption. Before creating and producing designs and using, customers must also refer to and comply with (a) the latest versions of all relevant TOSHIBA information, including without limitation, this document, the specifications, the data sheets and application notes for Product and the precautions and conditions set forth in the "TOSHIBA Semiconductor Reliability Handbook" and (b) the instructions for the application that Product will be used with or for. Customers are solely responsible for all aspects of their own product design or applications, including but not limited to (a) determining the appropriateness of the use of this Product in such design or applications; (b) evaluating and determining the applicability of any information contained in this document, or in charts, diagrams, programs, algorithms, sample application circuits, or any other referenced documents; and (c) validating all operating parameters for such designs and applications. **TOSHIBA ASSUMES NO LIABILITY FOR CUSTOMERS' PRODUCT DESIGN OR APPLICATIONS.**
- Product is intended for use in general electronics applications (e.g., computers, personal equipment, office equipment, measuring equipment, industrial robots and home electronics appliances) or for specific applications as expressly stated in this document. Product is neither intended nor warranted for use in equipment or systems that require extraordinarily high levels of quality and/or reliability and/or a malfunction or failure of which may cause loss of human life, bodily injury, serious property damage or serious public impact ("Unintended Use"). Unintended Use includes, without limitation, equipment used in nuclear facilities, equipment used in the aerospace industry, medical equipment, equipment used for automobiles, trains, ships and other transportation, traffic signaling equipment, equipment used to control combustions or explosions, safety devices, elevators and escalators, devices related to electric power, and equipment used in finance-related fields. Do not use Product for Unintended Use unless specifically permitted in this document.
- Do not disassemble, analyze, reverse-engineer, alter, modify, translate or copy Product, whether in whole or in part.
- Product shall not be used for or incorporated into any products or systems whose manufacture, use, or sale is prohibited under any applicable laws or regulations.
- The information contained herein is presented only as guidance for Product use. No responsibility is assumed by TOSHIBA for any infringement of patents or any other intellectual property rights of third parties that may result from the use of Product. No license to any intellectual property right is granted by this document, whether express or implied, by estoppel or otherwise.
- **ABSENT A WRITTEN SIGNED AGREEMENT, EXCEPT AS PROVIDED IN THE RELEVANT TERMS AND CONDITIONS OF SALE FOR PRODUCT, AND TO THE MAXIMUM EXTENT ALLOWABLE BY LAW, TOSHIBA (1) ASSUMES NO LIABILITY WHATSOEVER, INCLUDING WITHOUT LIMITATION, INDIRECT, CONSEQUENTIAL, SPECIAL, OR INCIDENTAL DAMAGES OR LOSS, INCLUDING WITHOUT LIMITATION, LOSS OF PROFITS, LOSS OF OPPORTUNITIES, BUSINESS INTERRUPTION AND LOSS OF DATA, AND (2) DISCLAIMS ANY AND ALL EXPRESS OR IMPLIED WARRANTIES AND CONDITIONS RELATED TO SALE, USE OF PRODUCT, OR INFORMATION, INCLUDING WARRANTIES OR CONDITIONS OF MERCHANTABILITY, FITNESS FOR A PARTICULAR PURPOSE, ACCURACY OF INFORMATION, OR NONINFRINGEMENT.**
- GaAs (Gallium Arsenide) is used in Product. GaAs is harmful to humans if consumed or absorbed, whether in the form of dust or vapor. Handle with care and do not break, cut, crush, grind, dissolve chemically or otherwise expose GaAs in Product.
- Do not use or otherwise make available Product or related software or technology for any military purposes, including without limitation, for the design, development, use, stockpiling or manufacturing of nuclear, chemical, or biological weapons or missile technology products (mass destruction weapons). Product and related software and technology may be controlled under the Japanese Foreign Exchange and Foreign Trade Law and the U.S. Export Administration Regulations. Export and re-export of Product or related software or technology are strictly prohibited except in compliance with all applicable export laws and regulations.
- Please contact your TOSHIBA sales representative for details as to environmental matters such as the RoHS compatibility of Product. Please use Product in compliance with all applicable laws and regulations that regulate the inclusion or use of controlled substances, including without limitation, the EU RoHS Directive. TOSHIBA assumes no liability for damages or losses occurring as a result of noncompliance with applicable laws and regulations.